

# INSTRUCTIONS FOR GASKETED JOINT SYSTEM WITH OUR TriSeal™

75 Wales, Saint-André-d'Argenteuil, Québec, CANADA J0V 1X0 | +1 450 537-3311 | Fax: +1 450 537-3415  
60 Greenhorn Drive, Pueblo, Colorado, 81004, USA | +1 719 565-3311 | Fax: +1 719 564-3415  
Toll free: +1 888 849-9909 | [frecomposites.com](http://frecomposites.com)

FRE<sub>®</sub> Conduit's Bell and Spigot design incorporates a factory installed one piece molded urethane TriSeal™ gasket, making the FRE<sub>®</sub> Conduit the easiest system on the market to install. Assembly does not require adhesives; cutting, threading or tapering, or any specialized equipment or skills. Pullout strength is approximately 500 lb. (227 kg) when installed correctly.

Assembly is in three (3) simple steps :

- Ensure gasket is in place and the Bell and Spigot are free from foreign objects.
- Align and insert Spigot into the mating Bell until the Spigot contacts the TriSeal™ gasket.
- Place a wood block against the opposite Bell end. Strike the block, until the Spigot is engaged to the drive line (factory marked line on the conduit spigot). Please note that in space restricted working areas, silicone or similar lubricant, applied to the spigot, will help make assembly easier.

\*\* Note: Do not force Spigot too far into the Bell as this may cause damage to the conduit system.

## INSTRUCTIONS

Even if the TriSeal™ gaskets were correctly installed at the factory, it is occasionally possible for a gasket to be dislodged from its installed position by rough handling during shipment. The installer should verify the inclusion of gaskets at every section of conduit or fitting is installed. When a TriSeal™ gasket has inadvertently fallen out, the following procedures will ensure its correct replacement in the fitting.

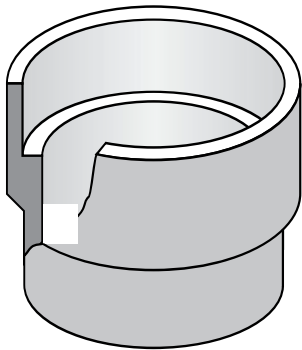

- 1 Examine the ledge inside the fitting to ensure that is free of dirt and debris.

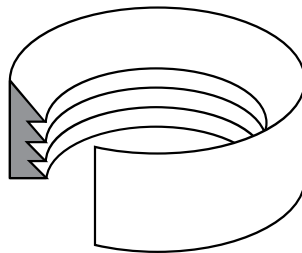

- 2 Obtain the TriSeal™ and check that it is in the correct configuration with the ribs pointing tthe inside. (If the TriSeal™ is not in the correct orientation, twist it inside out to correct it.)

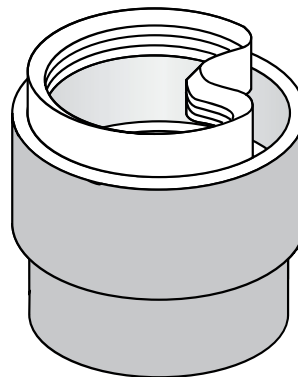

- 3 Deform the TriSeal™ into a kidney shape and place it (flat end first) into the fitting. When in position, snap the seal in place against the fitting along its entire circumference.

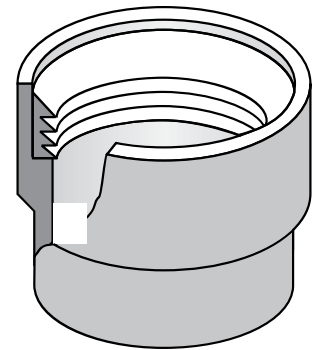

- 4 Depress the seal to ensure that it is correctly seated against the ledge of the fitting.

This document is the property of FRE Composites (2005) Inc. ("FRE Composites"). It shall not be used, reproduced, copied or transmitted to other persons without written authorization.